

FT CYLINDERS USE AND MAINTENANCE INSTRUCTIONS

Congratulations on your choice of a FT cylinder. To install, use and maintain Euro profile FT cylinders of the double (fig. 1), double clutch (fig. 2), single (fig. 3), single with knob cam (fig. 4), and double with adjustable cam (fig. 5) types carefully follow the instructions given here below. For additional information, directly contact FT or one of its authorised dealers.

A) GENERAL INFORMATION

- Make sure that the package is intact and that the Code Card (SERIES 3) and Security Card (SERIES 5) are contained in their special sealed bags.
- Keep in a safe, secret place the cylinder opening keys, the Code Card or Security Card.
- If one or more keys, the Code Card or the Security Card are stolen or lost, FT suggests to immediately replace the cylinder/s and the key/s to maintain the system security level unchanged.
- The cylinder should not protrude from the door outline by more than 3 mm to prevent picking with tools and offer increased resistance to "pulling".
- For increased security, we recommend the use of an escutcheon (see section E).
- Only use original FT keys.
- Only use intact and clean keys, discard bent keys.
- Do not leave the key in the cylinder for obvious security reasons and because this prevents using the key on the opposite side, which is necessary in case of emergency (double clutch-type models are an exception).
- Do not use the key to pull or push the door.
- Use silicone-based lubricants for cylinder lubrication (type Loctite N° 116, Tunpro 40, WD-40) at least once a year (twice a year for the double clutch-type models) (fig.10).
- Keep and check these instructions whenever necessary.
- Make sure that the lock and its locking elements (latchbolt and/or deadbolt/s) and the door and doorframe are perfectly matched and aligned to optimise the cylinder operation and consequently, your door opening.

WARNING: FT S.r.l. shall not be held responsible for any consequences resulting from the use of cylinders not in line with the above instructions. FT S.r.l. declines all responsibility for accidents or damage to persons or property resulting from alterations, structural or functional modifications, unsuitable or not correctly performed installation, use of NOT original key duplicates, poor maintenance or not correctly performed repairs.

B) INSTALLATION

1. Insert the cylinder by turning the cam by a few dozen degrees to make it fit within the cylinder body, using the opening keys (fig. 6). FT cylinders are equipped with a protruding cam to provide better lock anchoring and withstand attempted removal by hammering. It is therefore possible to insert the cylinder in, and extract it from, the lock without destructive actions, by simply having the opening keys available.
2. Fix the cylinder to the lock with the special fixing screw. Do not force the cylinder in during installation (fig. 6A). Note for cylinders with adjustable cam for knob (not included in the supply): use knobs compatible with the cam having the dimensions quoted in fig. 7. Cut the cam to the right measure and apply the knob securing it with the supplied fixing dowels.

C) USE

1. Insert the key all the way in.
2. Turn the key to work the lock.
3. Always remove the key after opening or closing for obvious security reasons. With double clutch-type cylinders, it is possible, but not recommended, to leave the key in on the cylinder inside. This model makes it possible to use another key from the outside even though a key is still in on the inside.
4. Do not turn the key when it is only partly inserted and do not force when turning the key (fig. 8).

D) REQUESTING A KEY DUPLICATE

- Models with Code Card (SERIES 3): Supply your original key or Code Card. FT recommends code duplication (check the code indicated on your key or Code Card) as this method enables to obtain identical copies (at outlets using electronic code duplication machines).
- Models with Security Card (SERIES 5): Supply your original key and Security Card. FT and authorised dealers will only make duplicates after a Security Card has been provided. A Security Card enables to obtain identical copies (at outlets using electronic code duplication machines).

The correct operation of all FT cylinders is only guaranteed if original FT keys are used.

NOTE ON KEY ARRANGEMENT SYSTEMS

In the event of master key systems, in addition to the Security Card supplied with the system, also supply the key/s that you wish to duplicate.

NOTE ON PERSONALISED KEY-WAYS

Certain outlets offer personalised key-ways (specially shaped key cross-section or key biting to make the key different from those supplied by other outlets or from the standard key). These key-ways are recognisable by the presence of the name of the authorised dealer stamped on the Security Card. Duplicates can be obtained from outlets where blanks are available.

E) ESCUTCHEONS FOR EURO PROFILE CYLINDERS (not included in the supply)

They act like shields around the cylinder and prevent cylinder picking with tools (drills and pulling tools). The FT escutcheons are characterised by a carbonitrided steel body and rotor by fixing through-bolts and by a not-easy-to-grip profile. Choose the most suitable escutcheon for your cylinder in the FT range for your (aluminium, wooden or reinforced) door, cylinder and lock according to your security requirements (fig. 9).

Products may be subject to changes aimed at improving performances.

Fig. 1

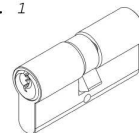

Fig. 2

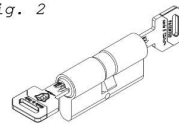

Fig. 3

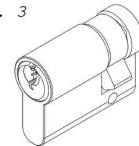

Fig. 4

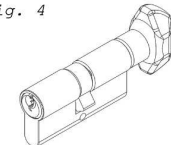

Fig. 5

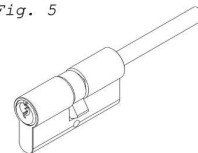

Fig. 6



Fig. 6A



Fig. 7

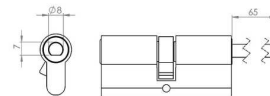

Fig. 8

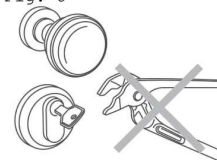

Fig. 9



Fig. 10

